

**Scraper**

<b>HEAPED CAPACITY</b>	20 yd <sup>3</sup> (15.3 m <sup>3</sup> )
<b>STRUCK CAPACITY</b>	14 yd <sup>3</sup> (10.7 m <sup>3</sup> )
<b>PAYLOAD</b>	48,000 lbs (21,800 kg)
<b>GROSS POWER</b>	352 hp (263 kW)

**FEATURES**

- New, power-down apron for positive closing and precision ejection
- Seven speed electronically controlled transmissions with sequential “bump” shift for smooth, low effort changes
- Cushioned bowl suspension for greater stability and productivity
- ROPS/FOPS panoramic operator’s compartment for superior visibility and comfort

**Specifications**

Engines		
	Tractor	Scraper
Make	Cummins	Cummins
Model/type series	QSB 5.9 L, 4 cycle Turbocharged	QSB 5.9 L, 4 cycle Turbocharged
Gross power @ 2,200 rpm (SAE J1995)	185 hp (138 kW)	167 hp (125 kW)
Net power @ 2,200 rpm (SAE J1349)	176 hp (131 kW)	158 hp (118 kW)
Engine emission meets Tier 2 USA EPA/CARB MOH 40 CFR and EU NRMM (Non-Road Mobile Machinery) Directive.		
Maximum torque @ 1,600 rpm	531 lb ft (720 Nm)	475 lb ft (644 Nm)
Cylinder configuration	6 in-line	6 in-line
Bore and stroke	4.01" x 4.72" (102 x 120 mm)	4.01" x 4.72" (102 x 120 mm)
Piston Displacement	360 in <sup>3</sup> (5.9 L)	360 in <sup>3</sup> (5.9 L)
Dry Air Cleaners. Electric start. 24 volt negative ground electrical system, with two 12 volt 165 Ah batteries. 100A alternator. Dual pedals allow synchronized operation of Tractor and Scraper engines or independent control of Tractor engine. An alarm warns in event of engine malfunction.		

## Specifications

### Transmissions (Front and Rear)

Funk DF158 Powershift, counter-shaft type transmission with integral torque converter. Seven speeds forward and one reverse. Automatic lockup in the top six forward gears. Manual, electric shifting and downshift inhibitor. An alarm warns in event of rear transmission malfunction.

	Forward							Reverse
Gear	1	2	3	4	5	6	7	R1
Ratio	5.72	4.05	2.90	2.03	1.45	1.03	0.74	4.05
mph	3.6	5.1	7.2	10.2	14.3	20.2	28.2	5.1
(kmh)	(5.9)	(8.3)	(11.5)	(16.5)	(23.1)	(32.5)	(45.4)	(8.3)

### Axles

Heavy duty, full floating with single reduction bevel gear differential and planetary reduction in each wheel.

Ratios:	Differential	4.11:1
	Planetary	5.33:1
	Total Reduction	21.91:1

A NoSpin differential is standard in rear axle for improved traction in difficult conditions.

### Tires and Wheels

#### Rim width

Standard	29.5 R 25 (**) Radial 25"
Optional	29.5-25 (28 PR) E-3 25"

Consult tire manufacturers for optimum tire selection and correct ton-mile/h (t-km/h) capacity for application.

### Brakes

Full air operated drum brakes with automatic application on loss of air pressure. Secondary system can also be manually applied. Spring-applied parking brake actuators. Independent brake circuits front and rear. Air dryer standard.

#### Braking lining:

Diameter	20" (508 mm)
Shoe width	6" (152 mm)
Lining thickness	0.75" (19 mm)
Lining area - each axle	520 in <sup>2</sup> (3,355 cm <sup>2</sup> )
Air compressor capacity	13.2 ft <sup>3</sup> /min (374 Lpm)

### Steering

Full hydraulic steering by two interchangeable single stage, double acting cylinders.

Full 90° swing right or left.

Pump capacity @ 2,200 rpm	38.7 gpm (147 Lpm)
System pressure @ 1,500 rpm	1,950 psi (135 bar)

### Hydraulics and Controls

Full flow filtered system with one reservoir supplying a triple section gear pump for steering and scraper hydraulics. Three finger-tip servo assisted levers allow independent operation of bowl, apron and ejector.

#### Scraper Functions:

Capacity @ 2,200 rpm 71.2 gpm (270 Lpm)

System pressure @ 1,500 rpm 1,500 psi (103 bar)

#### Servo Controls Pump:

Capacity @ 2,200 rpm 11.3 gpm (43 Lpm)

System pressure @ 1,500 rpm 250 psi (17 bar)

### Bowl

Bowl operated by two interchangeable double acting cylinders and linkage. Cutting edge down-force (bowl empty) 48,000 lbf (214 kN)

#### Volumes:

Struck (SAE) 14 yd<sup>3</sup> (10.7 m<sup>3</sup>)

Heaped 1:1 (SAE) 20 yd<sup>3</sup> (15.3 m<sup>3</sup>)

### Apron

Power down apron, operated by two, double acting cylinders with arms mounted outside bowl.

### Ejector

Positive roll-out type ejector operated by a single acting cylinder.

### Cutting Edge

The cutting edge is in four sections which allows either straight or variable length drop center. All the sections are interchangeable and reversible.

Dimensions 16.0 x 28.5 x 1.0" (406 x 724 x 25 mm)

### Weights

#### Net distribution

Tractor axle	56.6%	36,600 lbs (16,148 kg)
Scraper axle	43.4 %	27,322 lbs (12,393 kg)
Vehicle, net		62,922 lbs (28,541 kg)
Payload		48,000 lbs (21,770 kg)

#### Gross distribution

Tractor axle	50.9 %	56,456 lbs (25,608 kg)
Scraper axle	48.0 %	54,461 lbs (24,703 kg)
Vehicle, gross		110,917 lbs (50,310 kg)

## Specifications

Service Data	
<b>Tractor</b>	
Fuel tank	100.0 gal (378.0 L)
Engine crankcase (dry fill)	6.5 gal (24.6 L)
Cooling system	11.4 gal (43.0 L)
Transmission and converter	12.8 gal (48.5 L)
Drive axle	4.5 gal (17.0 L)
Hydraulic system	54.0 gal (204.0 L)
<b>Scrapper</b>	
Fuel tank	80.0 gal (303.0 L)
Engine crankcase (dry fill)	6.5 gal (24.6 L)
Cooling system	11.1 gal (42.0 L)
Transmission and converter	12.9 gal (49.0 L)
Drive axle	4.5 gal (17.0 L)

## Performance Data - 0% rolling resistance

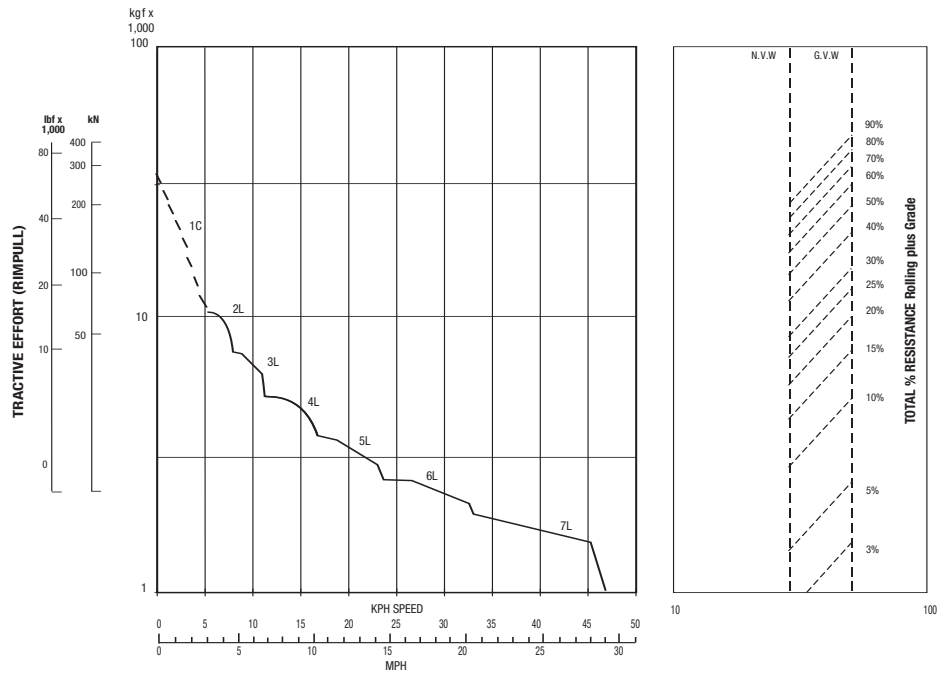

## Dimensions

Apron opening	6' 11" (2,100 mm)	Clearance under bowl	1' 11" (585 mm)
Width of bowl and cutting edge	9' 7" (2,910 mm)	Non-stop 180° turning width for vehicle clearance	60' 0" (18.4 m)
Width of cut	9' 10" (3,000 mm)	Overall length with optional twin hitch	
Depth of cut - maximum	1' 0" (305 mm)	Bail raised	45' 7" (13,900 mm)
Depth of spread - maximum	2' 3" (685 mm)	Bail lowered	47' 8" (14,340 mm)
Clearance under drive axle	1' 11" (585 mm)		

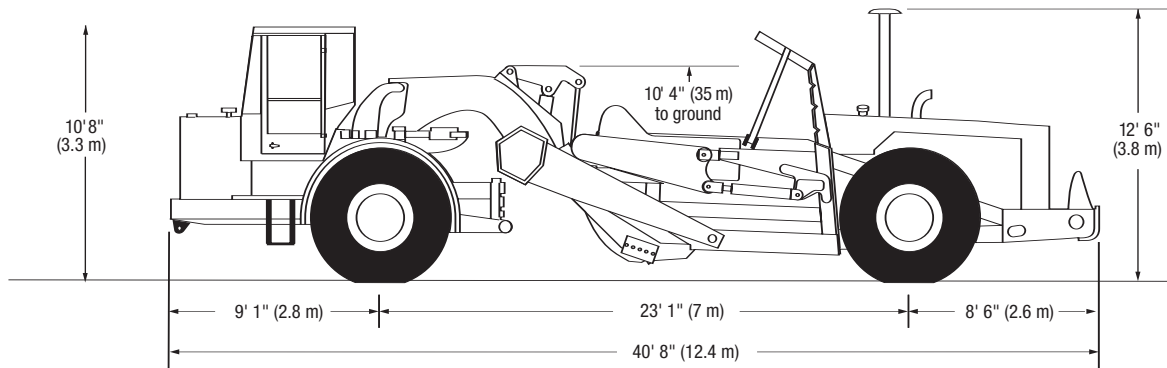
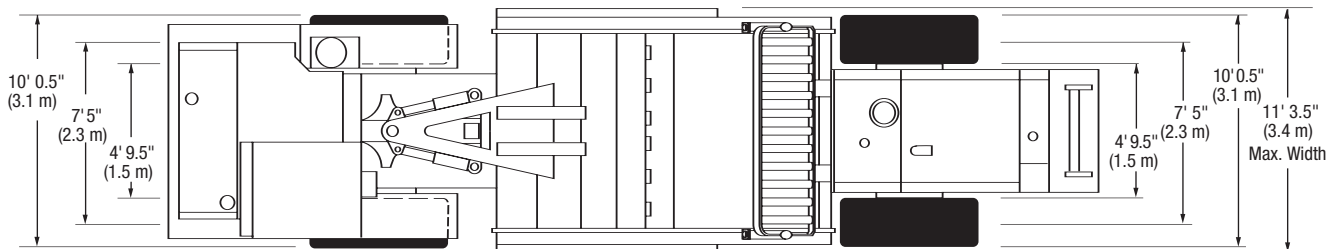

# Scraper TS14G

## Standard and Optional Equipment

### Standard Equipment

Air cleaners, two stage  
 Air conditioner R 134A 23,000 BTU/hr (6.74 kW)  
 Air dryer  
 Air horn  
 Air suspension seat, with arm rests  
 Battery disconnect switch  
 Brake drum guards  
 Cutting edge floodlight  
 Diagnostic test points  
 Downshift inhibitor  
 Exhaust mufflers  
 Fan guards  
 Fenders (front)  
 Full flow hydraulic system  
 Gear / diagnostic display unit  
 Headlights, quartz halogen (4)  
 Heater and Defroster 37,500 BTU/hr (11kW)  
 Inspection lamp socket, 24v  
 Interior light  
 Lubrication points, grouped, 4  
 Mirrors, rear view, RH and LH  
 Mug holder  
 Nitrogen inflated tires  
 NoSpin differential (rear)

Parking brake  
 Radio /cassette player (removable)  
 Reverse alarm, audible SAE J994)  
 Seat belt, retractable, (SAE J386)  
 Security kit  
 Servo scraper controls  
 Spillguard extension  
 Sun visor, roller type  
 Tinted glass  
 Tow points  
 Transmission guard (front)  
 Windshield washers and wipers, front and rear  
 Gauges, electric  
 Air pressure  
 Tachometer / hourmeter  
 Transmission temperature (front)  
 Transmission temperature (rear)  
 Indicators - Light and Alarm  
 Engine stop (front)  
 Engine stop (rear)  
 Transmission pressure (front)  
 Transmission pressure (rear)  
 Transmission temperature (rear)  
 Air pressure low  
 Indicator Lights only

Alternator not charging  
 Bowl suspension "on"  
 Direction Indicators  
 Engine check (front)  
 Engine check (rear)  
 Headlights, main beam  
 Service engine soon  
 Transmission filter (front)  
 Transmission filter (rear)  
 Operators compartment  
 ROPS / FOPS  
 SAE J1040C / ISO 3471  
 SAE J321 / ISO 3449  
 Side, tail, stop, direction  
 Indicators and hazard  
 Warning lights

### Optional Equipment

Fenders (rear)  
 Radiator guard, heavy duty (rear)  
 Roller push block (cannot be used with twin hitch)  
 Severe application  
 Modifications  
 Twin hitch  
 Tire inflation kit



### TEREX Construction Americas

8800 Rostin Road  
 Southaven, MS 38671  
 USA

TEL 662-393-1800  
 SALES 866-837-3923  
 PARTS & TECH SUPPORT 888-201-6008  
 FAX 662-393-1700  
 EMAIL sales@terexca.com  
 WEB terexca.com

For more information, product demonstration, or details on purchase, lease and rental plans, please contact your local TEREX Distributor.